

ADOLFO CHANDELIER

INSTALLATION INSTRUCTIONS

1 OF 7

BARONCELLI ⌘

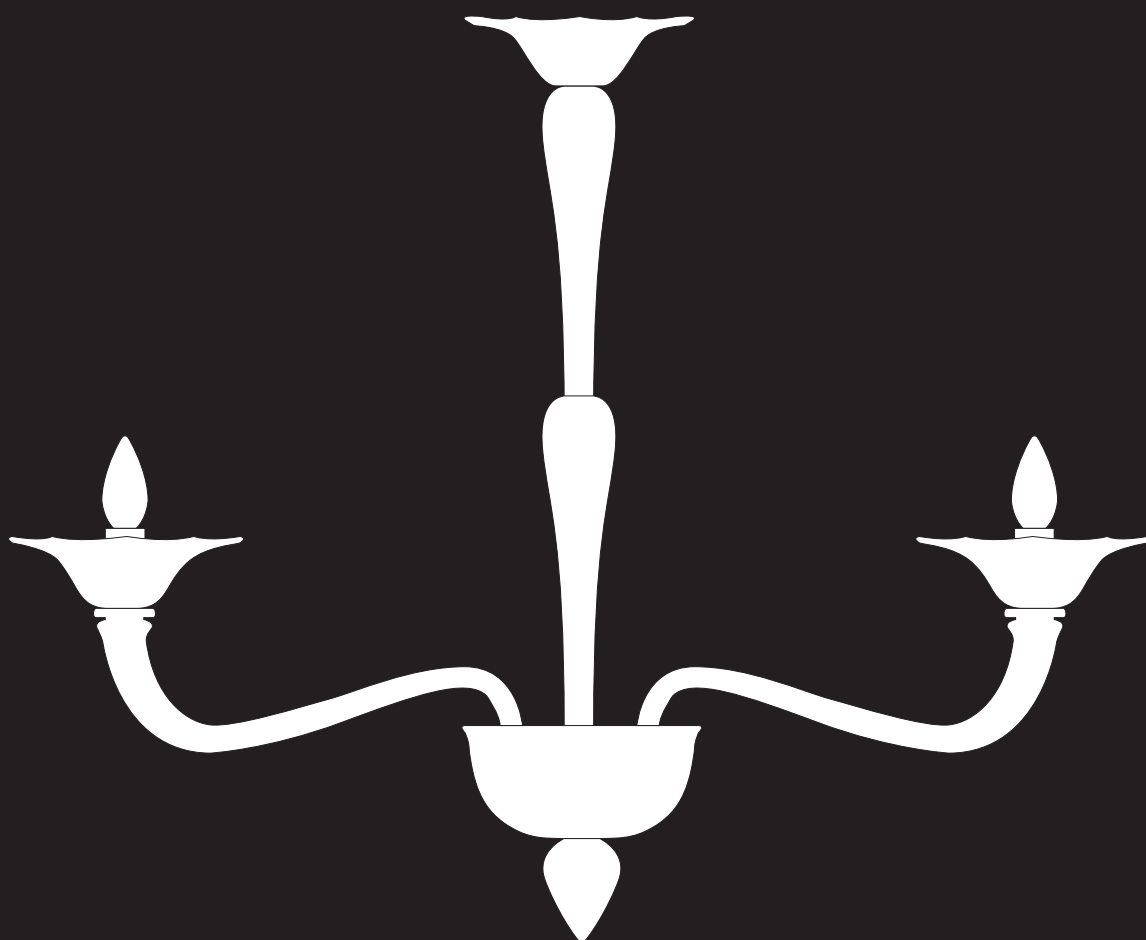

WHAT IS INCLUDED

1. Ceiling canopy
2. Chain
3. Spares
4. Bracket Bar (Junction box attachment)

WHAT YOU WILL NEED

1. Hook / Junction box fixings
2. Bulbs - E14 (240v) / E12 (120v) - Max 60W
3. Screwdriver (3.5mm / 1/8" flat tip) + pliers
4. Soft cloth

WEIGHTS

- 5 Lights 12kg (27LB)
- 6 Lights 13kg (27LB)
- 8 Lights 16kg (36LB)

ADOLFO CHANDELIER

INSTALLATION INSTRUCTIONS

2 OF 7

BARONCELLI ⌘



STEP 1

Using a heavy-duty hook secured firmly into a joist, hook the ceiling canopy and chain. Ensure hook is capable of taking the required weight.

NOTE: CEILING HOOK IS NOT SUPPLIED

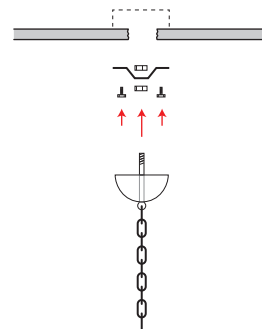

STEP 1 (U.S)

Securely fasten bracket bar to the junction box. Pass the stem through the bracket bar and secure using nuts above and below. Ensure the fixing is capable of taking the required weight.

NOTE: BRACKET IS NOT SUPPLIED

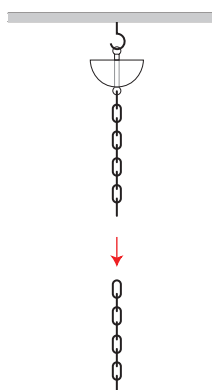

STEP 2

Remove excess chain to determine full drop.

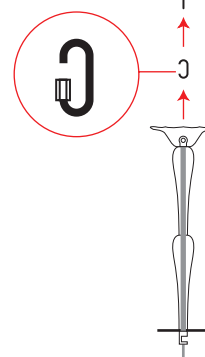

STEP 3

Use shackle to hook the stem to the chain.

ADOLFO CHANDELIER

INSTALLATION INSTRUCTIONS

3 OF 7

BARONCELLI ⌘

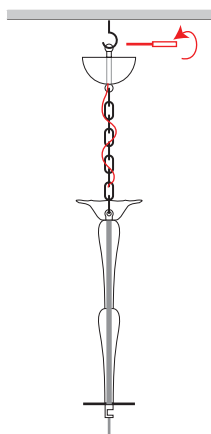

STEP 4

Thread cable up through the length of the stem, thread it through the chain and post up through the tube into the ceiling canopy. Make electrical connection.

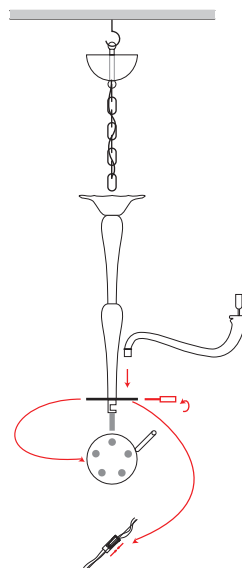

STEP 5

Install the arms into their corresponding sockets within the fondino plate. Secure into the socket below the plate and make electricals using 'click' connectors.

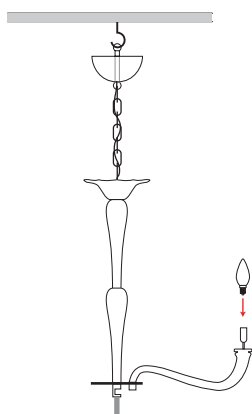

STEP 6

Install bulbs before testing electrics.

NOTE: E14 (240v) / E12 (120v) MAX - 60W

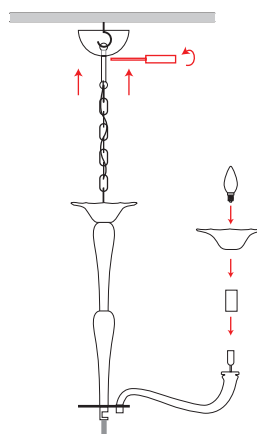

STEP 7

Raise ceiling canopy and secure in position. Install cup, candle sleeve and bulb onto each arm.

ADOLFO CHANDELIER

INSTALLATION INSTRUCTIONS

4 OF 7

BARONCELLI 

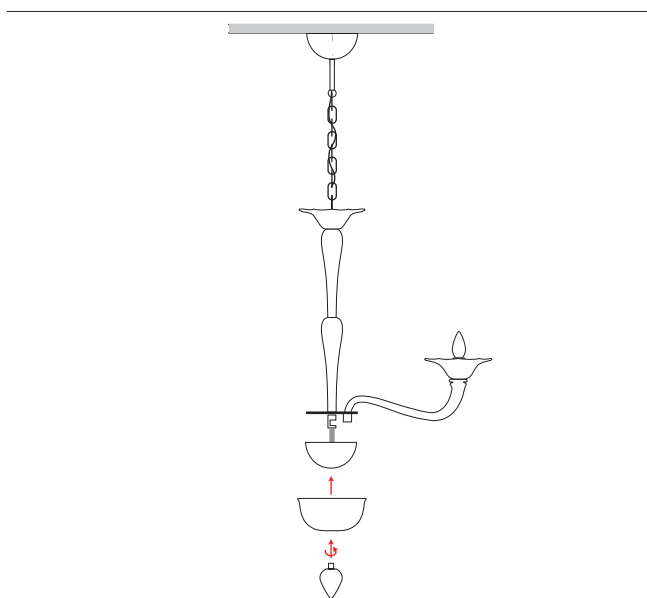

STEP 8

Raise fondino and metal liner into position and secure using finial beneath.

OPERATION AND MAINTENANCE

ENSURE ANY ELECTRICAL WORK IS CARRIED OUT BY A QUALIFIED ELECTRICIAN

5 OF 7

BARONCELLI ⌘

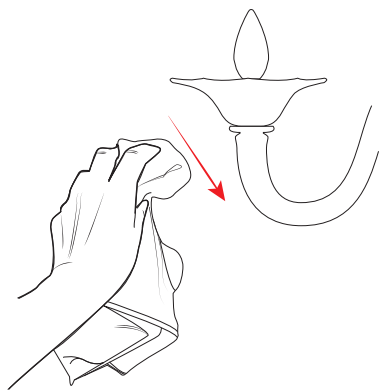

GLASS CLEANING

Glass elements should be carefully cleaned using a soft cloth.

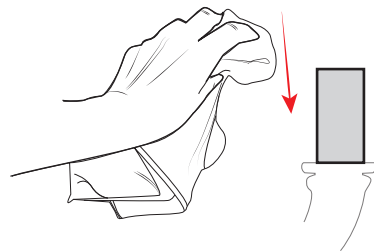

METAL CLEANING

Carefully clean metal surfaces using a soft cloth and no liquid.

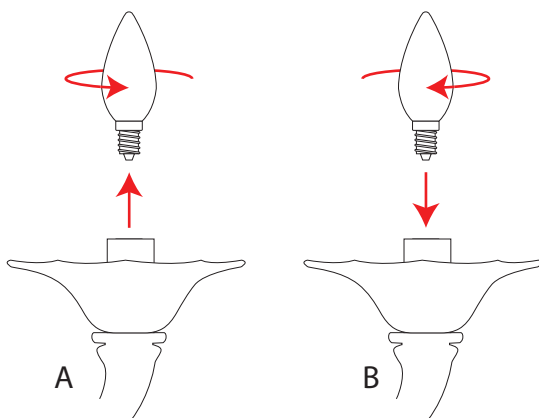

REPLACING A BULB

Ensure electricals are switched off and bulb has cooled down. Remove bulb and replace.

OPERATION AND MAINTENANCE

ENSURE ANY ELECTRICAL WORK IS CARRIED OUT BY A QUALIFIED ELECTRICIAN

6 OF 7

BARONCELLI 

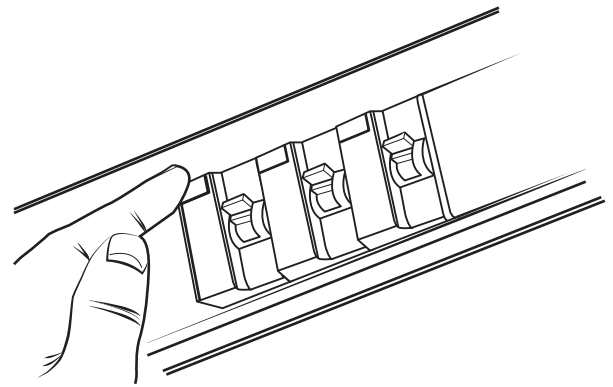

STEP A TROUBLE SHOOTING - ELECTRICAL FAULTS

If only a single bulb is not working, check, remove and replace the bulb.

NOTE: E14 (240v) / E12 (120v) MAX - 60W

STEP B TROUBLE SHOOTING - ELECTRICAL FAULTS

Check fuseboard

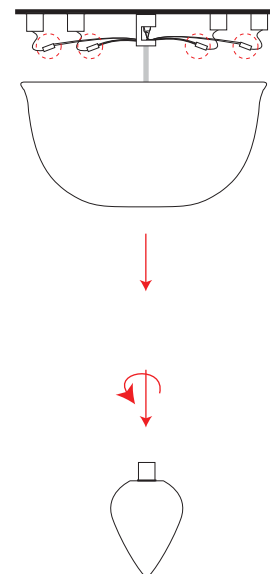
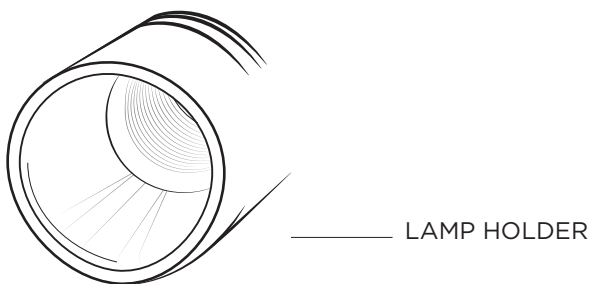

STEP C TROUBLE SHOOTING - ELECTRICAL FAULTS

Check/test lamp holder. Retrace installation steps to access.

STEP D TROUBLE SHOOTING - ELECTRICAL FAULTS

Remove finial and fondino to check/test connections at arm bases.

OPERATION AND MAINTENANCE

ENSURE ANY ELECTRICAL WORK IS CARRIED OUT BY A QUALIFIED ELECTRICIAN

7 OF 7

BARONCELLI 

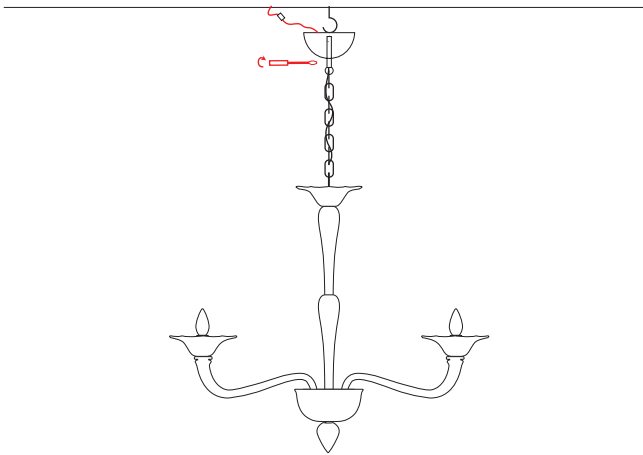

STEP E TROUBLE SHOOTING - ELECTRICAL FAULTS

Lower ceiling canopy. Check/test connections at arm arm bases.